

**SITE PLAN
-OF-**

LOT 1 OF CERTIFIED SURVEY MAP NO. 2675 AS RECORDED IN VOLUME 13 OF CERTIFIED SURVEY MAPS ON PAGE 276 IN THE WALWORTH COUNTY REGISTER OF DEEDS OFFICE, BEING LOCATED IN PART OF THE NORTHEAST 1/4 AND SOUTHEAST 1/4 OF THE SOUTHEAST 1/4 OF SECTION 29, AND THE SOUTHWEST 1/4 OF THE SOUTHWEST 1/4 OF SECTION 28, ALL IN TOWNSHIP 3 NORTH, RANGE 16 EAST OF THE FOURTH PRINCIPAL MERIDIAN, TOWNSHIP OF SUGAR CREEK, WALWORTH COUNTY, WISCONSIN

PREPARED FOR: 3D CONSTRUCTION
OWNER: NICHOLS

NOTE: SITE PLAN TO SHOW EXISTING DWELLING ONLY, ANY EXISTING IMPROVEMENTS ON PROPERTY NOT LOCATED.

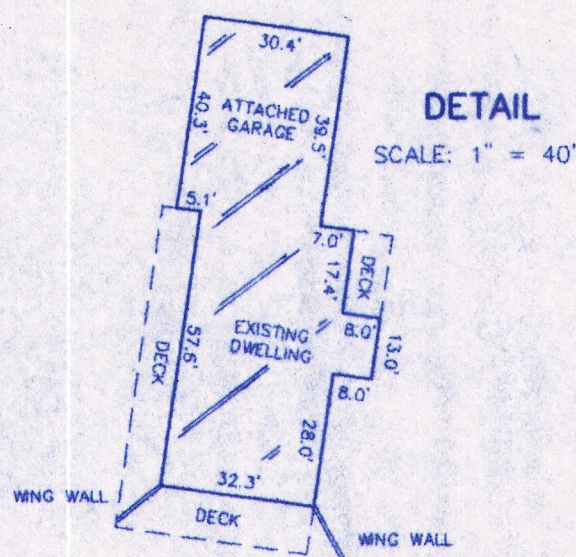

LOT 1
2,333,827 sq.ft.
53.58 acres
incl. right of way
2,328,485 sq.ft.
53.45 acres
excl. right of way

I CERTIFY THAT THE EXISTING DWELLING SHOWN ON THIS MAP IS LOCATED AS SHOWN, THUS (). DATED THIS 15TH DAY OF JUNE, 2015.

Robert J. Wetzel
ROBERT J. WETZEL S-1778

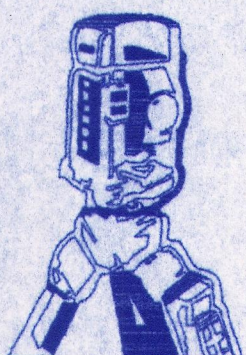

B.W. SURVEYING

412 N. PINE STREET
BURLINGTON, WI 53105
(414)-767-0225

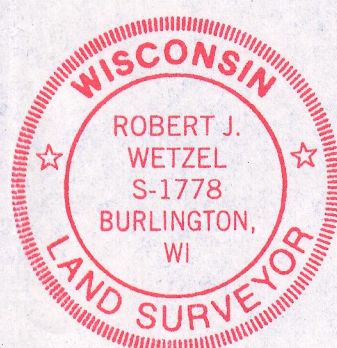

Robert J. Wetzel
ROBERT J. WETZEL S-1778

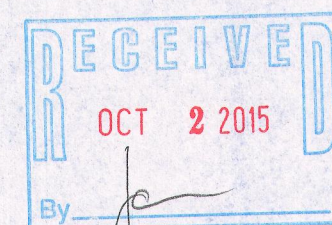

DRAWN BY:	bjw	DATE:	JULY 9, 2014
CHECKED BY:	bjw	DRAWING NO.:	8785d1
JOB NO.:	8785	SHEET	1 OF 1

GA2675-1 310-2235